

IP67

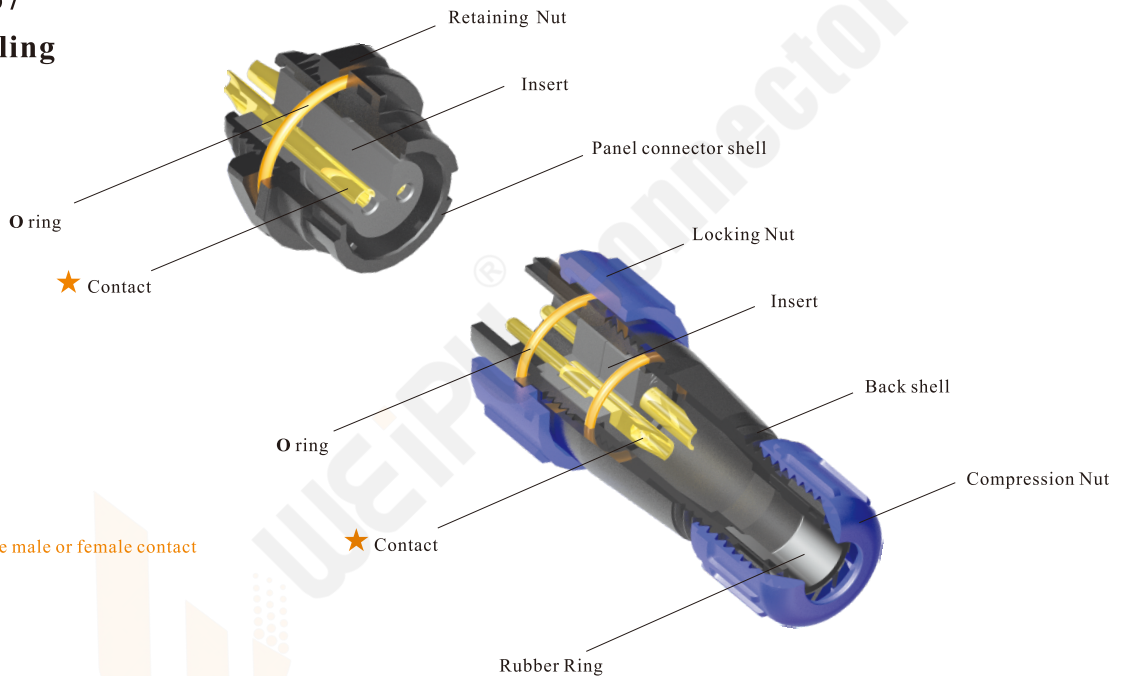

06

- SY Series IP67
- Bayonet coupling



Material and spec

Coupling	Bayonet	
Shell material	PC, Nylon66, fire resistance: V-0	
Insert material	PPS, max temperature 260 °C	
Contact material	Brass with gold plating	
Termination	Solder: SY11, SY13, SY17, SY21, SY25, SY29 Crimp: SY17, SY21, SY25, SY29 Screw: SY21, SY25, SY29(Ø2.5, Ø3, Ø3.5mm contact)	
Cable outer diameter range	SY11: I:3-4mm, II:4-6.5mm SY17: 6-10mm SY25: I:10-14mm , II: 7-12mm	SY13: I: 4-6.5mm , II: 5-8mm SY21: I: 4.5-7mm, II:7-12mm III:5-9mm SY29:I:9-13mm, II:13-16mm
IP rating	IP67	
Mating cycle	500	
Temperature range	-40°C~+85°C; -20°C ~+70°C	
Insulation resistance	2000 MΩ	

SY17 Series



Cable connector
Mate with SY1711,
SY1711C, SY1712

SY1710 / P _ _ _
SY1710 / S _ _ _

Male contact

1: solder, 3: crimp
Number of contact
Female contact

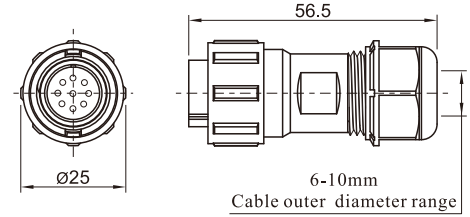

In-line cable connector C
Mate with SY1710

SY1711C / P _ _ _
SY1711C / S _ _ _

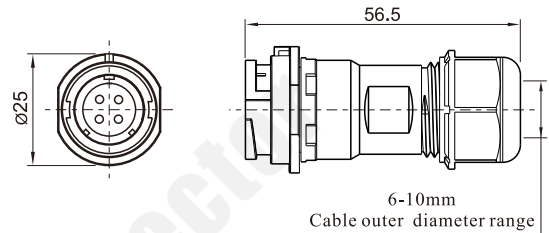

Rear-nut mount
Mate with SY1710

SY1712 / P _ _ _
SY1712 / S _ _ _

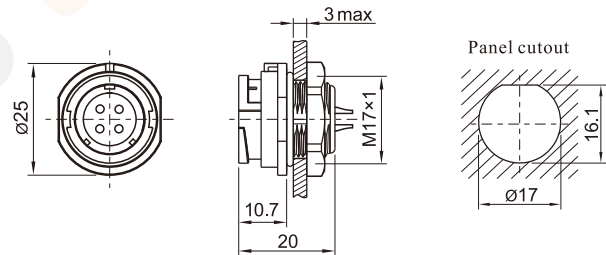

Solder contact spec

Number of contact	2	3	4	2B	3B	4B	5	7	9	10
Male contact face view										
Rated current (A)	10	10	5	15	15	15	5	5	5	5
Contact diameter(mm)	Ø1.5X2	Ø1.5X3	Ø1X4	Ø2X2	Ø2X3	Ø2X4	Ø1X5	Ø1X7	Ø1X9	Ø1X10
Rated voltage (AC.V)	500	500	500	500	500	500	500	400	400	400
Test voltage(AC.V) 1 min	1500	1500	1500	1500	1500	1500	1500	1200	1200	1200
Contact resistance (mΩ)	2.5	2.5	5	2.5	2.5	2.5	5	5	5	5
Wire size (mm ² /AWG)	≤2/14	≤2/14	≤0.75/18	≤2/14	≤2/14	≤2/14	≤0.75/18	≤0.75/18	≤0.75/18	≤0.75/18