

IP67

02

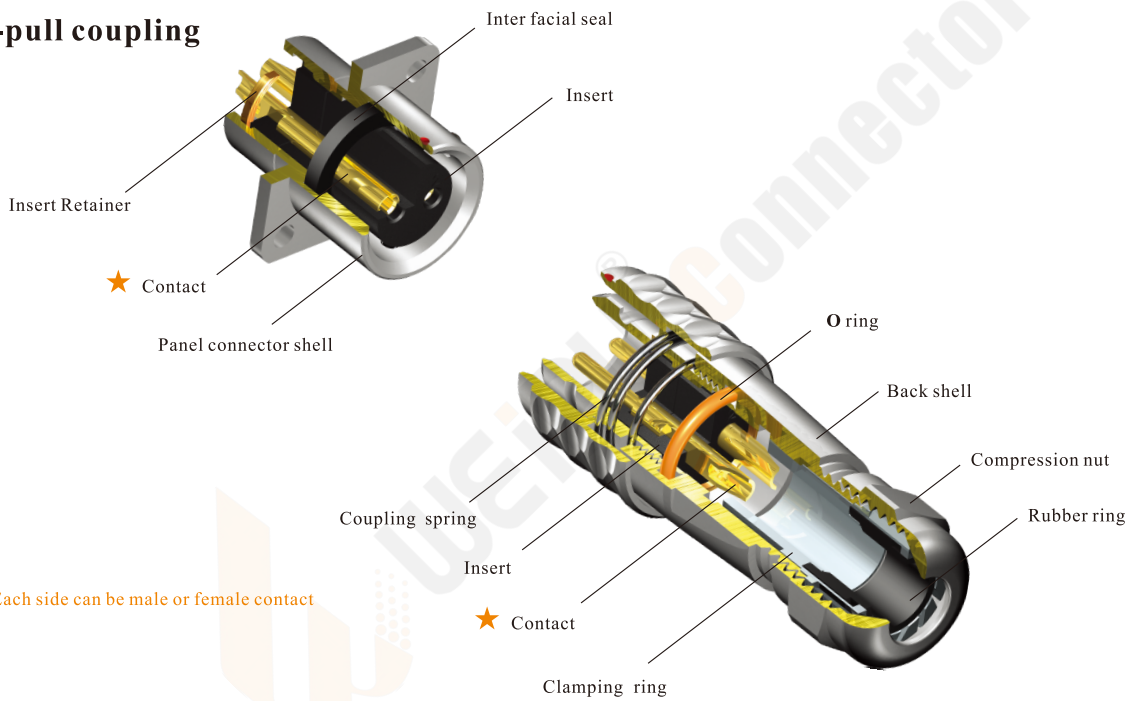

- SF Series IP67
- Push-pull coupling



Material and spec

Coupling	Push-pull
Shell material	Brass with chrome plating
Insert material	PPS max temperature 260 °C
Contact material	Brass with gold plating
Termination	Solder: SF6, SF8, SF10, SF12, SF16, SF20 Crimp: SF16, SF20 Screw: SF20 (Ø2.5mm contact)
Cable outer diameter range	SF6: I: 2-3mm, II: 3-4mm SF12: I: 4-6.5mm, II: 5-8mm SF8: I: 3-4mm, II: 4-5mm SF16: I: 5-8mm, II: 8-12mm SF10: I: 3-4mm, II: 4-6.5mm SF20: I: 5-9mm, II: 8-12mm
IP rating	IP67
Mating cycle	500
Temperature range	-40°C ~ +85°C
Insulation resistance	2000MΩ

SF8 Series

02



Cable connector
Mate with SF811B, SF812B,
SF815B

SF810B/P SF810B/S

Male contact

Cable outer diameter range
I: 3-4mm, II:4-5mm
Number of contact
Female contact

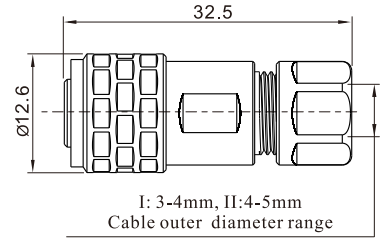
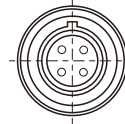

In-line cable connector
Mate with SF810B

SF811B/P SF811B/S

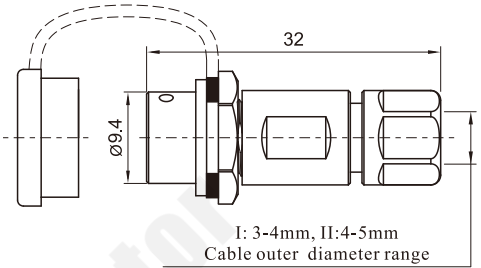
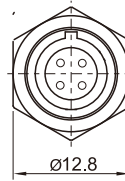

Rear-nut mount
Mate with SF810B

SF812B/P SF812B/S

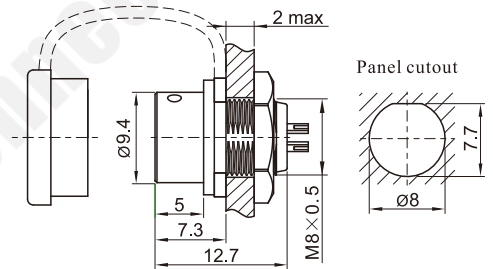
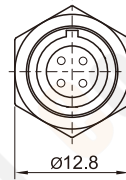

Front-nut mount
Mate with SF810B

SF815B/P SF815B/S

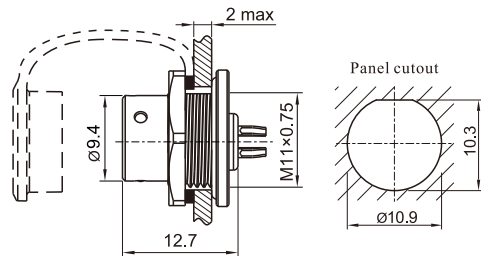
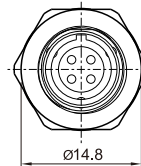

Solder contact spec

Number of contact	2	3	4	6	8
Male contact face view					
Rated current (A)	5	5	3	3	3
Contact diameter(mm)	Ø1×2	Ø1×3	Ø0.6×4	Ø0.6×6	Ø0.6×8
Rated voltage (AC.V)	125	125	30	30	30
Test voltage(AC.V) 1 min	1000	1000	500	500	500
Contact resistance(mΩ)	5	5	10	10	10
Wire size(mm ² /AWG)	≤0.75/18	≤0.75/18	≤0.5/20	≤0.5/20	≤0.5/20